



TENANT INFORMATION PACKET

Building Number: # _____ Unit Number: # _____

Tenant Name: _____ Date of Birth _____

Cell # _____ Office # _____

Home # _____ Email: _____

Tenant Name: _____ Date of Birth _____

Cell # _____ Office # _____

Home # _____ Email: _____

Alternative Mailing Address: _____

EMERGENCY CONTACT:

Name: _____ Relationship: _____ Phone # _____

Name: _____ Relationship: _____ Phone # _____

Does Emergency Contacts have a key to your unit? _____

OTHER OCCUPANTS IN UNIT:

Name: _____ Relationship: _____

Name: _____ Relationship: _____

OTHER OCCUPANTS IN UNIT UNDER THE AGE OF 12:

Name: _____ Relationship: _____

Name: _____ Relationship: _____

Tenant signature _____ Date _____

Tenant Signature _____ Date _____

Management Signature _____ Date _____



PET INFORMATION

Please read section 17.3 of the Declaration regarding pet restrictions (attached). Please provide a picture of pet(s) when returning this packet to the management office.

Building # _____ Unit # Number: # _____

Do you have any pets? _____ How many? _____

DETAILED PET INFORMATION

Type of Pet: (1) _____

Pet's Name: _____ Breed _____ Color: _____ Weight _____ Age _____

Type of Pet: (2) _____

Pet's Name: _____ Breed _____ Color: _____ Weight _____ Age _____

ASSOCIATION PET RULES:

- PET MUST BE NO MORE THAN 35 LBS FOR DOGS AND 15 LBS. FOR CATS.
- ALL SERVICE AND EMOTIONAL SUPPORT ANIMALS MUST GO THROUGH AN APPLICATION PROCESS TO VERIFY LEGITIMACY.
- ONE PET PER BEDROOM. TWO PETS MAXIMUM.
- PET OWNERS ARE REQUIRED TO PICK UP ANY SOLID WASTE FROM THEIR PET WHEN WALKING OUTSIDE AND DISPOSED OF PROPERLY. THERE ARE DOGGIE STATIONS LOCATED THROUGH OUT THE PROPERTY.
- PETS MUST ALWAYS BE ATTENDED BY AN ADULT AND BE RESTRAINED WITH A LEASH NO MORE THAN 6 FEET IN LENGTH WHEN OUTSIDE ON COMMON GROUNDS.

OWNERS ACKNOWLEDGMENT

I AM AWARE OF THE VILLAS AT EMERALD DUNES CONDOMINIUM CONCEPTS RULES, REGULATIONS, AND RESTRICTIONS REGARDING PETS ON THE PROPERTY AND AGREE TO ABIDE BY THEM.

Name: _____ Building #: _____ Unit #: _____

Signature: _____ Date: _____

Name: _____ Building #: _____ Unit #: _____

Signature: _____ Date: _____



Installations

No radio station or short wave operations of any kind shall operate from any Unit, Limited Common Elements or Common Elements. Except to the extent permitted under applicable laws, no exterior satellite dish, or other transmitting or receiving apparatus, radio antenna, television or other antenna of any type shall be erected or maintained on the common elements, Limited Common Elements, or Units, without the prior written consent of the Association. Notwithstanding the forgoing, upon obtaining the prior written consent of the association, satellite dishes and other devices permitted under applicable law, may be installed within the units or within any Limited Common Elements appurtenant thereto, provided, however, that in no event shall any such device be installed in or on any other portion of the Condominium Property. To the extent permissible under applicable law, the Association may enact Rules and Regulations, requiring that any devices which may be permitted under applicable law are comparable in size and weight and appearance, are installed and maintained in a manner designed to protect the safety of the buildings and its occupants and satisfy any standards established by the association for architectural appearance purposes. In addition, the foregoing is subject to (and the Unit Owners agree to be bound by) the provisions of the Cable/Internet Agreement referred to in the Section of this Prospectus entitled "Management of the Association and Maintenance and Operation of the Condominium Property". In the event that a Unit Owner wishes to install a satellite dish or individual antenna, Unit Owners agree to be bound by and comply with the terms and provisions on any Satellite Dish and Antenna Addendum referred to as Exhibit "G" in the Cable/Internet Agreement. The foregoing is subject to the provisions of Section 8.2.13 and other applicable provisions of the Master Covenants.

For these and other restrictions upon the use of Units and Common Elements, reference should be made to all Exhibits contained in this Prospectus (particularly Sections 9 and 17 of the Declaration) the Rules and Regulations attached to the By-Laws.

I have received information on satellite dishes. If I wish to install one, I must first fill out an architectural modification form for the Board's Approval.

Signature _____ Date _____

Signature _____ Date _____



EMERALD DUNES GOLF COURSE NOTICE

Being a resident of Emerald Dunes does not give you access of any kind to the golf course. Anyone found on the golf course without the authorization of the Emerald Dunes Golf Club will be prosecuted. If you are not a member of the Emerald Dunes Golf Club, please do not enter the course without their approval.

THE VILLAS AT EMERALD DUNES WILL NOT BE HELD LIABLE FOR ANY OF YOUR ACTIONS ON THE EMERALD DUNES GOLF COURSE.

We have received the Rules and Regulations from the monument office and will abide by the rules of the association as it pertains to the Villas at Emerald Dunes.

Name: _____ Building # _____ Unit Number: # _____

Signature: _____ Date: _____

Name: _____ Building #: _____ Unit Number: # _____

Signature: _____ Date: _____



Vehicle Registration

Name: _____

Phone: _____

ALL REGISTERED VEHICLES MUST HAVE THEIR DECALS DISPLAYED AT ALL TIMES AND ANY UNAUTHORIZED OR ILLEGALLY PARKED VEHICLES ARE SUBJECT TO TOW AT VEHICLE OWNERS EXPENSE.

Vehicle 1: Make: _____ Model: _____ Color: _____

Tag: _____ State: _____

(The following will be provided at orientation) Parking Space Number: _____

Decal Type: Assigned Rental Space Expire Date: _____

Vehicle 2: Make: _____ Model: _____ Color: _____

Tag: _____ State: _____

(The following will be provided at orientation) Parking Space Number: _____

Decal Type: Assigned Rental Space Expire Date: _____

Vehicle 3: Make: _____ Model: _____ Color: _____

Tag: _____ State: _____

(The following will be provided at orientation) Parking Space Number: _____

Decal Type: Assigned Rental Space Expire Date: _____

Notice to Driver: Resident must notify management if the vehicle is sold. All unauthorized vehicles which are parked on the subject property and all vehicles parked on the subject property in unauthorized places shall be towed at the sole discretion of the Manager, and at the vehicle owner's or operator's expense. Resident agrees to hold Manager harmless, defend, and indemnify the Manger for any expense or damages caused by the towing of unauthorized and or illegally parked vehicles from the Apartment community property. Any vehicles parked on sidewalks, in fire zones or in other unauthorized spaces, or inoperable vehicles or those without a current license tag shall be towed at Residents' expense.

Signature Vehicle (1): _____ Date: _____

Signature Vehicle (2): _____ Date: _____

Signature Vehicle (3): _____ Date: _____



OWNER AND TENANT ORIENTATION

Most of this information is provided in the rules and regulations (attached)

Emerald Dunes Employees:

Amy Trimble – Property Manager

Nelson Chavez – Maintenance Manager

Glenda Cope– Administrative Assistant (Email: Gcope@grsmgt.com)

Office Number: 561-684-3140 Fax: 561-684-3690 Mon-Fri 9 am to 5:30 pm

Security Number 561-507-4307 (card given) Mon-Fri 5 pm to 3 am Sat-Sun 10 am to 5 am

Please read orientation form thoroughly

New Owner/Tenant at Building: Bldg.

a) Garbage:

There are two garbage containers on the property, located on one on phase 1 in the middle of the property behind the gates and the other on phase 2 on the right side of the main right gate. Please bag and break down all items for cleanliness. Children 12 and under are not permitted in or around trash/compactor area. Trash is not to be left sitting outside of the compactor. If the compactor is not working correctly or is at full capacity, please call management. Cigarette butts are to be disposed properly and not be thrown in bushes or roads as this is considered a violation.

_____ **INITIALS** _____ **INITIALS**

b) Animals Restrictions:

All animals must be on a leash not more than six (6) feet long. Also, when walking your animals, any solid waste must be picked up and discarded. If you live in a one-bedroom unit you may only have one cat or dog (**cat = 15, dog = 35**) If you live in a two or three bedroom you may have 2 animals EXAMPLE: (2 dogs under 35lbs =70lbs total) (2 cats under 15lbs = 30lbs total) (1 dog 35lbs 1 cat 15lbs =50lbs total). Aggressive breeds (Pit-bull, Rottweiler and Boxer) are **NOT permitted** on property. All service and emotional support animals must apply to prove legitimacy. **Owners must provide vaccination records and a photo of your pet; vaccination records are to be update yearly.**

_____ **INITIALS** _____ **INITIALS**

c) Parking:

****Available monthly rental spaces are limited. ****

If you should have visitors, you will find the visitors parking scatted throughout the property labeled as GUEST in yellow. **Guest parking is only for 48 hours consecutive or not anything after that you must call the Management office to obtain a guest parking decal or rent an additional parking space for \$50.00 a month.** If parked in a guest space or another resident’s assigned space your vehicle is in violation and eligible to be towed. In addition, any lettering or commercial/advertisement print on any vehicles while parking on property



OWNER AND TENANT ORIENTATION

is **NOT permitted**. No commercial vehicles are permitted on the property overnight. If you have a garage, it is to be used as a parking not storage as they are not made to sustain stored items and have very little ventilation. If an additional space is needed you may request to rent a parking space monthly. Parking is prohibited in front of Detached Garages. Additionally, every unit has assigned parking spaces and cannot be switched with other unit owners or tenants.

Parking Space # _____ **INITIALS** _____ **INITIALS**

d) Front door-Common Area/ Balconies

No Articles other than patio-type furniture shall not be placed on balconies linens, cloths, towels, clothing, curtains, rugs, mops, children’s toys, bikes, or scooters etc. grills are **NOT permitted** on balconies or in common areas, however there is a designated area with grills on property, see sitemap. Our community thrives on cleanliness if you should make a mess in front of your door or in the common area you are responsible to clean it, if not this will result in a violation. You may have a couple of plants, but not an excessive amount and the plants cannot be hanging off the balcony or railing. Hanging lights & lanterns are **NOT permitted**. **The following items around the exterior of your unit FOR EXAMPLE: are not permitted (shoes, umbrellas, container, garbage bags, bikes, or loose trash)** Please be advised violators will be issued a violation & fine.

_____ **INITIALS** _____ **INITIALS**

e) Pool:

Pool hours are 24 hours (**deck**) Dawn to Dusk (**inside water**). Any glass or alcohol inside the pool area are NOT permitted. Any children under the age of 12 must be always supervised when inside the pool gates. No diving, jumping or large floatation devices are **NOT permitted**. Please dry off when entering bathrooms to avoid anyone slipping on wet floors. All residents and guest must always have their assigned (**red**) amenity pass on them. Renters, please confirm with your landlord to receive a amenities pass, please be advised each amenity pass is \$15.00

_____ **INITIALS** _____ **INITIALS**

f) Gym:

Gym hours are open 24 hours. All residents and guest must always have their assigned (**red**) amenity pass on them Free weights are not permitted to be thrown on the floor to prevent damages to weights and flooring. Any children under the age of 12 must be always supervised in addition, parents are responsible for their safety and use of any equipment. Medicine balls are not permitted to be thrown at the wall and equipment must be used properly. Wipes are provided and should be disposed. Renters, please confirm with your landlord to receive a amenities pass, please be advised each amenity pass is \$15.00

_____ **INITIALS** _____ **INITIALS**



OWNER AND TENANT ORIENTATION

g) Additional information:

Any repairs on vehicles on property is **NOT permitted**. All vendors/contractors must register with the management office and sign in. Vendors and contractors are authorized on the property Monday-Friday 9:00 AM – 4:30 PM excluding weekends. Moving vehicles/trucks are limited to size to what is authorized on property & are not permitted to park on property overnight. Please note that we have cameras around at all main gates and club houses. If you should ever need to review them, please contact Samantha at the management office.

Visitors/call box

h) For all guests visiting your unit they must go to the callbox at the main gates and locate the letter of your last name and ring the phone number programmed into the call box, once the phone rings to your phone then dial 9 to grant access.

Name:

Phone#

Mailbox:

To allow a visitor access into the gate please dial 9:

Broad Star Pamphlet √

Key Fob Controls

Map of Community √

1- Main Gate Vehicle Access

Business Card and Security Card √

2- Programmable Garage Opener

Parking Decal √

3- Clubhouse Doors

Rules and Regulations √

4- Pedestrian Gates

Signing this document acknowledges that you have had the orientation with management, have retrieved the “Rules and Regulations”, understanding the rules pertaining to **Garbage, Security, Animals, Parking, Balconies, Pool and Common Area.**

Owner or Tenant Signature _____ Date _____

Owner or Tenant Signature _____ Date _____

Owner or Tenant Signature _____ Date _____

Management Signature _____ Date _____

Requesting Access with a Visitor Call

- Navigate to Resident Directory using Navigation keys.
- Scroll through the alphabet to the first letter of the last name.
- Press Enter.
- Scroll through name list to desired entry.
- Press Enter to call.
- If the visitor already knows the resident's directory number, they can enter the directory number to call the resident.
- The system dials the resident's telephone number to establish 2-way communications.

NOTE: The resident's telephone number will never be displayed to the visitor.

- If the resident is using the telephone at the same time a visitor calls, the display will indicate to the visitor that the line is busy.
- The resident answers the call and converses with the visitor to determine if access will be granted.
- The resident can use their telephone's keypad to grant access activating Relay Channel "A" by pressing **9**. After access is granted, the system will disconnect the visitor and resident call.
- The resident can disconnect the visitor without granting access by pressing ***8** or by hanging up.

NOTE: The telephone keys that the resident presses can be customized for the installation.

- The length of time the visitor is allowed to talk can be programmed from 30-300 seconds.

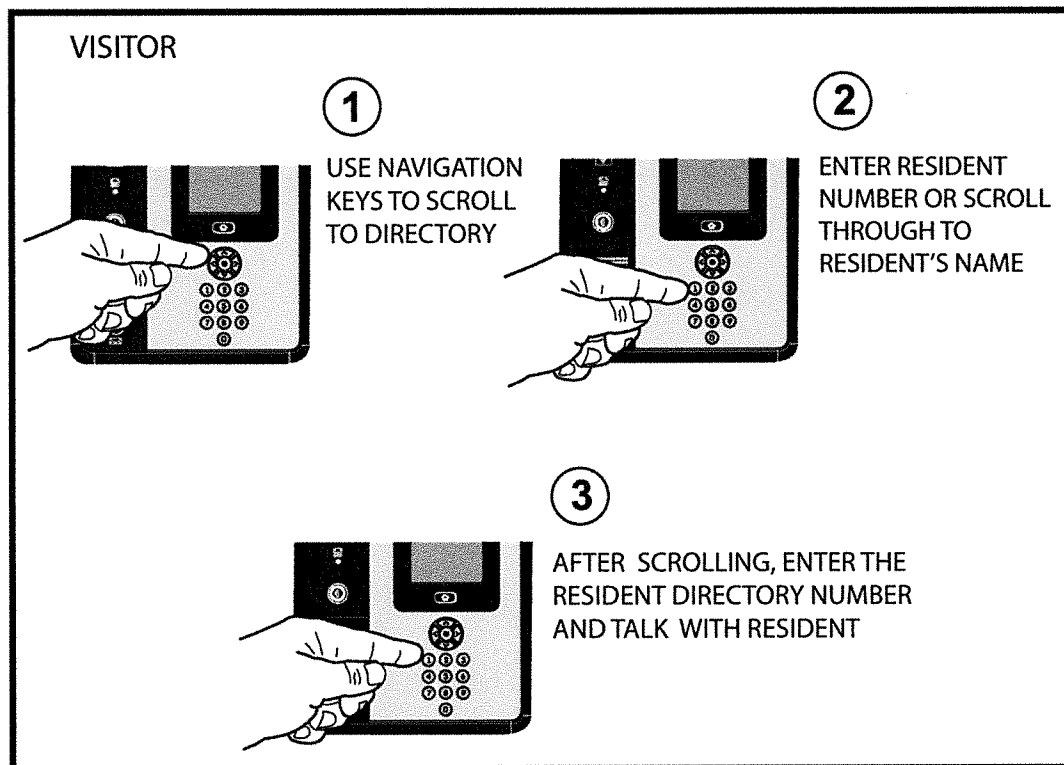

Test and Maintenance Operations

Prior to installation, ensure that all inside wiring is secure. Each unit should be checked annually for any loose wire connections.

Impaired Operation

Units are designed to operate under adverse environmental conditions. Under normal circumstances, they will function properly regardless of outside conditions. However, units do not have secondary power sources and cannot function without direct continuous power. If a unit is damaged by natural causes or deliberate vandalism, it may not function properly depending on the level of damage.



The Villas AT EMERALD DUNES

Golf Course Club House

FAIRWAY 9

FAIRWAY 1

VISTA PARKWAY

EMERALD DUNES DRIVE

FAIRWAY 2

OKEECHOBEE BLVD.

FLORIDA BUILDING CODE.





The Villas
AT EMERALD DUNES

SECURITY 561-507-4307
MEDICAL, FIRE, LAW ENFORCEMENT 911
MANAGEMENT OFFICE 561-684-3140



AMY TRIMBLE
COMMUNITY ASSOCIATION MANAGER
6442 Emerald Dunes Drive · West Palm beach, FL 33411
Office 561-684-3140 · Fax 561-684-3690
atrimble@grsmgt.com · www.grsmgt.com



GLEND A COPE
ADMINISTRATIVE ASSISTANT
6442 Emerald Dunes Drive · West Palm Beach, FL 33411
Office 561-684-3140 · Fax 561-684-3690
gcope@grsmgt.com · www.grsmgt.com

WALLY PRIME DIGITAL / HD CABLE

LIGHTNING INTERNET

200+ DIGITAL CHANNELS
with HD CHANNELS



UP TO 500 MBPS
INTERNET

\$84.99*
/month
with bundled discount

Wally Prime Digital/HD Cable 200+ Basic Digital channels with HD & 1 Wally Receiver

\$25*/mo

Local Channels	166 CMT	205 FOX News	192 ID	170 Nickelodeon	122 Syfy
9393 3ABN	208 CNBC	180 Freeform	259 INSP	171 Nickelodeon W	260 TBN
118 A&E	200 CNN	103 Free Preview Info	227 Jewelry TV	178 Nick Toons	139 TBS
886 Alma vision	107 Comedy Central	9415 Free Speech TV	108 Lifetime	189 OWN	400 Tennis Channel
195 American Heroes	113 Cooking Channel	119 FYI	109 Lifetime Movies	127 Oxygen	232 The Cowboy channel
131 AMC	221 CRAFT	229 Gem Shopping Network	9410 Link TV	241 Paramount Network	183 TLC
184 Animal Planet	210 C-SPAN	401 Golf Channel	254 LOGO	071 QVC	138 TNT
167 AXS TV	211 C-SPAN2	116 Gameshow Network	152 MLB Network	255 QVC2	196 Travel Channel
823 Baby First	263 Daystar	130 HD Net Movies	246 Motor Trend	299 Reelz Channel	242 truTV
124 BET	9645 Deal	185 Hallmark Channel	209 MSNBC	9644 Renew	106 TV Land
203 Bloomberg TV	194 Destination America	187 Hallmark Movies	160 MTV	231 RFD-TV	105 USA Network
129 Bravo	182 Discovery Channel	202 Headline News	161 MTV2	280 RT America	162 VH1
9403 BYU TV	114 E! Entertainment	120 History Channel	163 MTV Classic	225 Sale	121 Viceland
176 Cartoon Network	9411 Enlace	880 HITN	369 MTV Live	193 Science Channel	881 V-ME
177 Cartoon Network W	224 EPIC	112 HGTV	286 NASA	257 Shahid VIP	214 Weather Channel
158 CBS Sports Net	261 Eternal World	074 HSN	186 National Geo	134 ShopHQ	128 WE
279 CGTN News	9642 FETV	268 Impact Network	156 NBA TV	276 Smart	228 YouTV
884 CGTN Espanol	110 Food Network	230 In Country Network	154 NFL Network	257 Sonlife Broadcasting	70+ SiriusXM Channels
267 Christian TV	206 FOX Business News	133 Independent Film	157 NHL Network	395 Sportsman Channel	30+ DishCD Music Channels

ADDITIONAL CABLE PACKAGES All options below require America's Top 120 or above

America's Top 120 190+ Digital channels

\$82.99*/mo

9393 3ABN	107 Comedy Central	9642 FETV	074 HSN	170 Nickelodeon E	139 TBS
118 A&E	289 Comet	243 FM	268 Impact Network	171 Nickelodeon W	232 The Cowboy Channel
131 AMC	253 Cozi TV	110 Food Network	230 In Country Network	241 Paramount Network	258 The Hillsong Channel
219 America's Voice	166 CMT	206 FOX Business News	133 Independent Film	117 Pop	138 TNT
184 Animal Planet	221 CRAFT	205 FOX News Channel	134 INSP	393 Pursuit Channel	399 TVG
167 AXS TV	210 C-SPAN	150 FOX Sports 1	192 ID	284 Recipe Channel	398 TVG2
218 Binge TV	211 C-SPAN2	180 Freeform	227 Jewelry TV	071 QVC	106 TV Land
360 Black News	263 Daystar	103 Free Preview Info	240 Justice Central	255 QVC2	105 USA Network
359 Bounce	278 DEAL	9415 Free Speech TV	108 Lifetime	299 Reelz Channel	104 Value TV
370 Circle	182 Discovery Channel	164 FUSE	9410 Link TV	9644 Renew	881 V-ME
129 Bravo	172 Disney Channel E	136 FX	250 ION	280 RT America	162 VH1
245 BUZZR	173 Disney Channel W	125 FXX	247 ME TV	225 Sale	214 Weather Channel
084 BuyTV	9411 Enlace	248 GAC Living	246 Motor Trend	257 Sonlife Broadcasting	215 Weather Nation
9403 BYU TV	114 E! Entertainment	229 Gem Shopping Network	209 MSNBC	659 Shahid VIP	239 WGN America
176 Cartoon Network E	224 Epic	373 Get TV	160 MTV	276 Smart	128 WE
177 Cartoon Network W	261 EWTN	217 GRIT	161 MTV2	291 Start TV	228 YouTV
279 CGTN News	140 ESPN	202 Headline News	369 MTV Live	122 Syfy	70+ SiriusXM Channels
884 CGTN Espanol	143 ESPN2	293 Heroes and Icons	286 NASA	183 TLC	30+ DishCD Music Channels
267 Christian TV	142 ESPNnews	120 History Channel	197 National Geographic	196 Travel Channel	
208 CNBC	141 ESPNU	880 HITN	216 Newsmax	242 truTV	
200 CNN	387 Family Movie Classics	112 HGTV	283 Newsy	260 TBN	

America's Top 200 240+ Digital channels Includes channels in AT120

\$97.99*/mo

402 ACC Network	174 Disney XD	185 Hallmark Channel	396 Outdoor Channel	157 NHL Network	828 Univision West
135 BBC America	111 DIY	187 Hallmark Movies	127 Oxygen	260 TBN	188 UP
124 BET	852 Estrella	250 ION	231 RFD-TV	139 TBS	121 Vice
410 Big Ten Network	149 FOX Sports 2	109 Lifetime Movies	193 Science Channel	400 Tennis	396 World Fishing
175 Boomerang	119 FYI	407 Longhorn Network	408 SEC	181 Teen Nick	858 Zona Futbol
158 CBS Sports Network	833 Galavision	152 MLB Network	126 Sundance TV	856 TUDN	70+ SiriusXM Channels
113 Cooking Channel	401 Golf Channel	169 Nick Jr.	190 Nat Geo WILD	132 Turner Classic Movies	30+ DishCD Music Channels
179 Discovery Family	116 GSN	389 Olympic Channel	156 NBA TV	830 UniMÁS E, W	
168 Disney Jr.	186 Hallmark Drama	189 OWN	154 NFL Network	827 Univision East	

America's Top 250 290+ Digital channels Includes channels in AT200

\$107.99*/mo

195 American Heroes	254 LOGO	346 StarzEncore Classic
392 beIN Sports	377 MoviePlex	348 StarzEncore Español
873 beIN en Español	163 MTV Classic	347 StarzEncore Family
251 BET her	178 Nick Toons	344 StarzEncore Suspense
203 Bloomberg TV	367 Smithsonian	342 StarzEncore Westerns
194 Destination America	395 Sportsman Channel	329 The Movie Channel W
292 Epix Drive-In	340 StarzEncore E	330 The Movie Channel Xtra W
384 FOX Movie Channel	341 StarzEncore W	838 Universo
244 Fusion	343 StarzEncore Action	
165 GAC Family	345 StarzEncore Black	

Additional channels

Requires America's Top 200 or 250

Multi-Sports Pack

\$13*/mo

NFL RedZone, NFL Network, Pac-12 Networks, Big Ten Network, NBA TV, NHL Network, MLB Network, MLB Strike Zone, FXX, Fox Sports 2, Universal Sports Network and over 20 Regional Sports Networks.

SHOWTIME: 9 Channels \$15*/mo | STARZENCORE: 8 Channels \$10*/mo

**Customer Service: 561-472-5006 or online at
BroadStar.com/EmeraldDunes**

*Channels available in HD are printed in bold. Local blackout restrictions may apply. Programming and prices subject to change and do not include taxes, equipment, and applicable fees such as the Broadcast TV Fee. Up to 500 Mbps Internet speeds are available via hard-wired Ethernet connections and on compatible devices. v.1.11.22 DS



Welcome to BroadStar

GET LIGHTNING INTERNET SPEEDS UP TO 500 Mbps!



Basic Cable TV:
80+ BASIC channels
RECEIVER NOT REQUIRED

**INCLUDED
IN YOUR
COMMUNITY**

3 Gate Channel	28.1 BET	56.1 Weather channel
2.1 Guide channel	29.1 Oxygen	57.1 TLC
3.1 ABC WPBF	30.1 WE	58.1 Animal Planet
4.1 NBC WPTV	31.1 BRAVO	59.1 Hallmark
5.1 CBS WPEC	32.1 HDNET Movies	60.1 Hallmark Movies
6.1 FOX WFLX	33.1 AMC	61.1 OWN
7.1 CW WTVX	34.1 IFC	62.1 ID
8.1 PBS WXEL	35.1 QVC	63.1 Science channel
9.1 ION WPXP	36.1 QVC Plus	64.1 Travel channel
10.1 Court TV WHDT	37.1 TNT	65.1 Nat Geo
11.1 USA	38.1 TBS	66.1 CNN
12.1 TruTV	39.1 Paramount Network	67.1 Headline News
13.1 Comedy Central	40.1 Fusion	68.1 Bloomberg TV
14.1 TV Land	41.1 Dish Studio	69.1 FOX News
15.1 Lifetime	42.1 Azteca America	70.1 FOX Business
16.1 Lifetime Movies	43.1 CBS Sports Net	71.1 CNBC
17.1 FOOD Network	45.1 MTV	72.1 MSNBC
18.1 DIY	46.1 MTV2	73.1 CSPAN
19.1 HGTV	47.1 VH1	74.1 CSPAN2
20.1 Cooking channel	48.1 MTV Classic	75.1 Destination America
21.1 E! Entertainment	49.1 CMT	76.1 The Cowboy channel
22.1 Gameshow Network	50.1 AXS	77.1 LOGO
23.1 A&E	51.1 Nickelodeon	78.1 REELZ
24.1 FYI	52.1 Nickelodeon W	79.1 RFD-TV
25.1 History channel	53.1 Cartoon Network	80.1 Cartoon Network W
26.1 Viceland	54.1 Discovery channel	
27.1 SYFY	55.1 Freeform	

Lightning Internet
UP TO 500 MBPS

\$59⁹⁹*
/mo
with Bundled
Discount

BROADSTAR



BroadStar.com/EmeraldDunes



Customer Service: 561-472-5006

\$25*/mo

WALLY PRIME DIGITAL/HD CABLE

200+ Digital channels with HD & 1 HD receiver

Local Channels		
25 ABC (WPBF)	9411 Enlace	154 NFL Network
17 Azteca (WWHB)	224 EPIC	157 NHL Network
12 CBS (WPEC)	261 Eternal World	170 Nickelodeon
34 CW (WTVX)	9642 FETV	171 Nickelodeon W
29 FOX (WFLX)	110 Food Network	178 Nick Toons
67 ION (WPXP)	206 FOX Business News	189 OWN
5 NBC (WPTV)	205 FOX News	127 Oxygen
42 PBS (WXEL)	180 Freeform	241 Paramount
21 TBN (WTCE)	103 Free Preview Info	071 QVC
	9415 Free Speech TV	255 QVC2
Additional Channels		
9393 3ABN	119 FYI	299 Reelz Channel
118 A&E	229 Gem Shopping Network	9644 Renew
886 Alma vision	401 Golf Channel	231 RFD-TV
195 American Heroes	116 GSN	280 RT America
131 AMC	130 HD Net Movies	225 Sale
184 Animal Planet	185 Hallmark Channel	193 Science Channel
167 AXS TV	187 Hallmark Movies	257 Shahid VIP
823 Baby First	202 Headline News	134 ShopHQ
124 BET	120 History Channel	276 Smart
203 Bloomberg TV	880 HITN	257 Sonlife Broadcasting
129 Bravo	112 HGTV	395 Sportsman
9403 BYU TV	074 HSN	122 Syfy
176 Cartoon Network	268 Impact Network	260 TBN
177 Cartoon Network W	230 In Country Network	139 TBS
158 CBS Sports Net	133 IFC	400 Tennis Channel
279 CGTN News	192 ID	232 The Cowboy channel
884 CGTN Espanol	259 INSP	183 TLC
267 Christian TV	227 Jewelry TV	138 TNT
166 CMT	108 Lifetime	196 Travel Channel
208 CNBC	109 Lifetime Movies	242 truTV
200 CNN	9410 Link TV	106 TV Land
107 Comedy Central	254 LOGO	105 USA Network
113 Cooking Channel	152 MLB Network	162 VH1
221 CRAFT	246 Motor Trend	121 Viceland
210 C-SPAN	209 MSNBC	881 V-ME
211 C-SPAN2	160 MTV	214 Weather Channel
263 Daystar	161 MTV2	128 WE
9645 Deal	163 MTV Classic	228 YouTV
194 Destination America	369 MTV Live	70+ SiriusXM Channels
182 Discovery Channel	286 NASA	30+ DishCD Music Channels
114 E! Entertainment	186 Nat Geo	
	156 NBA TV	

561-472-5006 | BroadStar.com/EmeraldDunes

*Channels available in HD are printed in bold. Local blackout restrictions may apply. Prices subject to change and do not include taxes, equipment, and applicable fees such as the Broadcast TV Fee and the Regional Sports Network Fee. Up to 500 Mbps Internet speeds are available via hard-wired Ethernet connections and on compatible devices. Programming subject to change without notice. v.1.19.22 DS